

LAG SCREW FASTENING REQUIREMENTS :

2 LAG SCREWS PER FOOT OF PANEL (EXCEPT AT VENTS), TYPICAL. LOCATIONS WITH DESIGN SNOW LOADS GREATER THAN 30 psf UP TO 120 psf REQUIRE 3 LAG SCREWS PER FOOT PF PANEL.

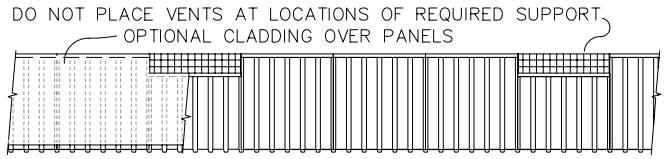

DROPPED PANELS FOR VENTILATION:

ANY 1 IN 4 CONTIGUOUS PANELS MAY HAVE THE TOP LOCATION LOWERED TO CREATE VENTILATION OPENINGS, TYPICAL OF ALL INSTALLATIONS EXCEPT AT THE END WALLS OF SINGLE-WIDE UNITS (WHICH CAN HAVE NO VENT OPENINGS). TYPICAL WALLS MUST HAVE MIN 2 PANELS BETWEEN ANY 2 OPENINGS. OPENINGS SHALL BE SCREENED WITH 1/4" MESH. A CRAWL-SPACE ACCESS OPENING CAN SUBSTITUTE FOR ANY VENT OPENING.

COAT OVER THE GALVANIZED PANELS PRIOR TO BACKFILL. LEAVE NO VOIDS IN THE COAT.

BACKFILL CAN BE PLACED UP TO 3' HIGH TYP. GRADES MUST SLOPE 2% MIN OVER 5' AWAY MIN. OK TO FILL UP TO ANY CLADDING THAT IS OK FOR SOIL CONTACT. KEEP SOIL 6" MIN CLEAR OF BLDG.

SPECIFICATIONS

MATERIALS

- ALL PANEL STEEL MATERIAL TO MEET ASTM A-653 18 GA (0.043") MIN, GRADE 40 MIN, G-210 GALV MIN.
- TOP DETAIL SCREWS TO BE HD GALV OR ZINC PLT.
- PANEL DEFORMATIONS AT BOTTOM TO MEET DETAILS.
- IN-SITU CONCRETE 28 DAY STRENGTH TO BE 2500psf.
- REINFORCING BARS PER ASTM A-615 GRADE 40 MIN.

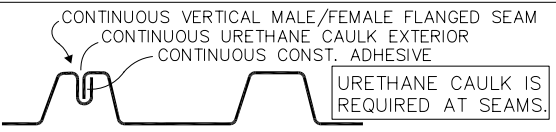

PLAN/SECTION DETAIL @ SEAM

SEAMS AT 3' O/C ABOUT THE PERIMETER TYPICAL

CONTINUOUS PANELS AROUND ENTIRE HOME WITH VENT-PANELS AND ACCESS OPENINGS INSTALLED PER THIS SHEET ONLY. END WALLS OF DBL-WIDE HOMES CAN HAVE ONLY 2 VENT OR DOOR OPENINGS, UNLESS FASTENED WITH 3 LAG SCREWS PER FOOT OF PANEL.

SIDING / SHEATHING AND SHEAR TRANSFER PER BLDG MNFTR. TRIM AND FINISH OF FDN ATTACHMENT TO SUIT THE PROJECT ARCHIT'L REQUIREMENTS.

#10 SDST SCREWS AT 6" O.C. TYP FOR RIM CHANNEL OF 18 GAGE MIN, OR PER SPECIFIC REQ'MTS OF GIVEN M.H. CONSTRUCTION, PER PROJECT-SPECIFIC ENGINEERING REVIEW.

TOP ALTERNATE FOR STEEL CONSTRUCTED BUILDINGS

WOOD RIM W/O SPACER SHOWN HERE.

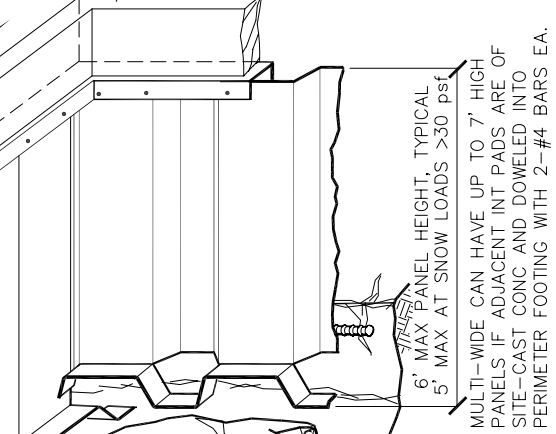

ANCHORPANEL PERIMETER

VIEW FROM THE INTERIOR DURING CONCRETE PLACEMENT

INSTALLATION

- FOUNDATION WALL PANELS TO BE ATTACHED PER TOP & SEAM DETAIL BEFORE CONCRETE PLACEMENT.
- TOP FOOTING REBAR SHALL BE USED TO TRUE PANELS.
- CONCRETE SHALL BE PLACED BY PUMP, AND PANELS SHALL BE CHECKED FOR PLUMB (+/- 2%) BEFORE CONCRETE HAS SET. EXTERIOR CONCRETE SHALL SLOPE AWAY FROM PANELS.
- FOUNDATION PANELS MAY BE CLAD WITH CEMENTITIOUS PANELS FOR PROTECTION FROM SOIL BACKFILL, PROVIDING CEMENTITIOUS PANELS EXTEND TO AND SEAL AT FOOTING TO PREVENT INFESTATION IN AREAS OF HIGH TERMITE RISK, AND THEY ARE SUITABLE FOR SUB-GRADE ENVIRONMENTS.

CONTINUOUS #4 MIN REBAR AT PANELS, 24" MIN LAPS.

FOOTING: MIN 12" WIDE BY 12" BELOW EXT. FINISH GRADE

ANCHORAGE FLANGE PER PANEL MANUFACTURE - MUST BE FIELD-BENT WITH A TOOL PROVIDED BY FAST TRACK.

CONTINUOUS #4 MIN LOWER REBAR, 24" MIN LAPS.

TRENCH DEPTH ACCORDING TO CK.

LOCAL FROST REQ'MTS, IF ANY.

BOTTOM

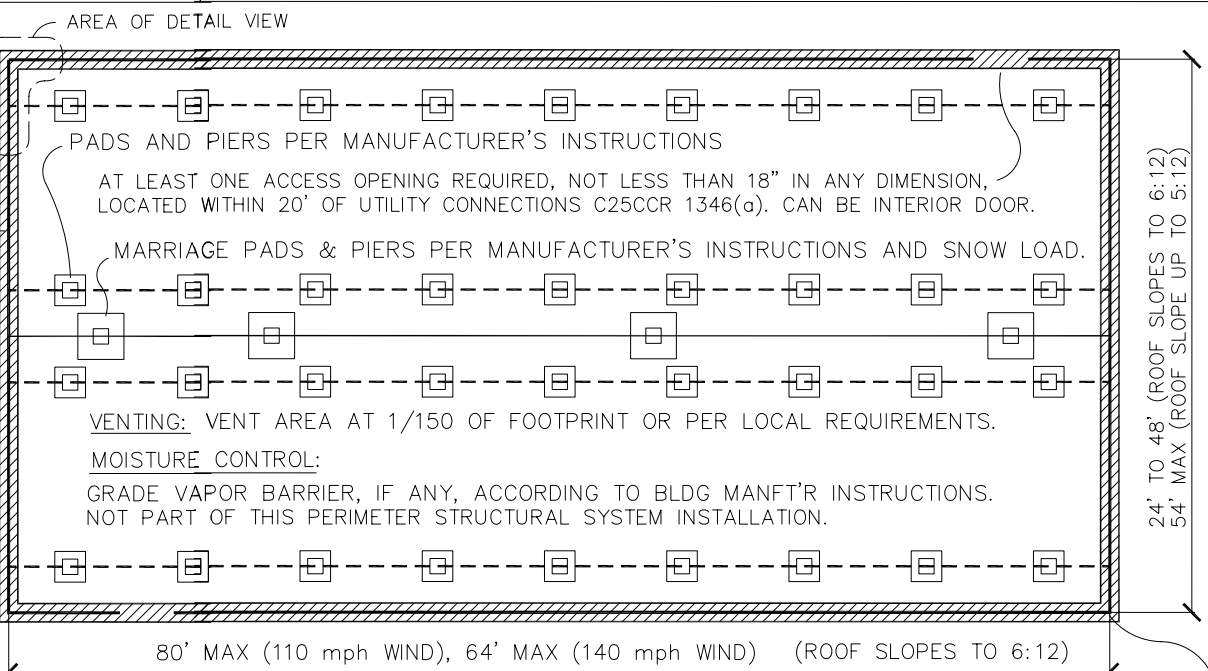

MULTIPLE-WIDE PLAN

N.T.S.

PANELS FOLD AROUND CORNERS (W/50% SAW KERFING) OR PANEL EDGES ARE CAULKED TOGETHER AT CORNERS.

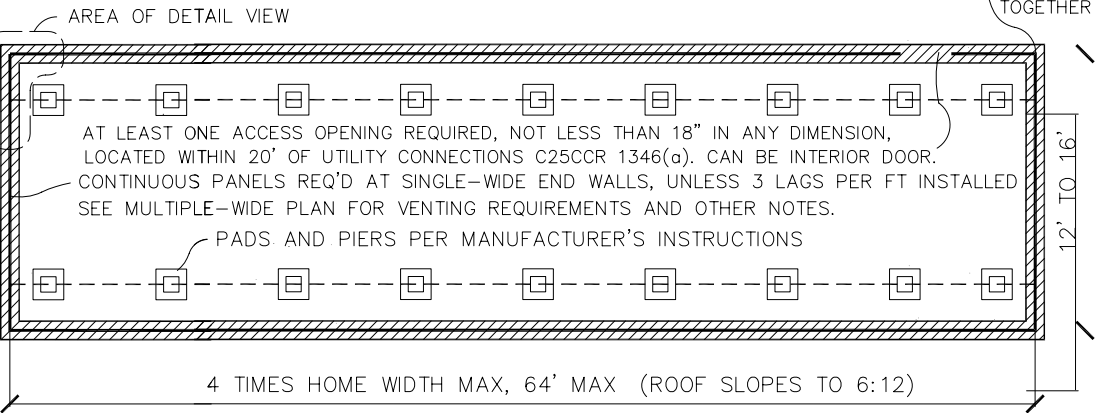

SINGLE-WIDE PLAN

N.T.S.

UP TO 110 mph WIND ONLY (ROOF SLOPES TO 6:12)

THIS DESIGN DOES NOT CONSTITUTE A SITE EVALUATION. SUITABILITY OF SITE CONDITIONS FOR THIS OR ANY FOUNDATION IS NOT IMPLIED.

NOTE: FOR SNOW LOADS OVER 100 psf FOOTING WIDTH MUST BE WIDENED TO 15" AND CLEARANCE FROM PANEL BTM TO BTM OF TRENCH MUST BE INCREASED TO 6" MIN

DESIGN LOADS

PER 2013 CRC AND PER 2013 CBC, WHERE CRC SECTION 301.1.3 APPLIES.

ROOF LIVE LOAD: 30 psf

MAX SNOW LOAD: 120 psf

FLOOR LIVE LOAD: 50 psf

M.H. UNIT WEIGHT: 50 psf max, 22 psf min.

SEISMIC ZONE: ANY LOCATION IN CA (BESIDES SITE CLASS "F" REQUIRING GEOTECH REVIEW)

SEIS Ss=2.22, Fa=1.0 at Ss>1.25, Sds=1.48

WIND LOAD: 110 to 140 mph Exp C

*FOR Ss>2.22 OR WIND Exp D, CONTACT US

INSTALLATION / SITE REQUIREMENTS

- PROPERLY INSTALLED ANCHORPANEL WILL PROVIDE LOAD-SPREADING GRADE-BEAM PROPERTIES SUPERIOR TO ANY INTERIOR PIER OR TIE-DOWN FOUNDATION SYSTEM.
- SOIL CONDITIONS SHOULD BE SUITABLE FOR CONVENTIONAL CONSTRUCTION, WITH A MINIMUM BEARING STRENGTH OF 1000psf. CLAYS WHICH ARE TOO EXPANSIVE FOR CONVENTIONAL FOUNDATION CONSTRUCTION SHALL NOT BE BUILT UPON WITHOUT A GEOTECHNICAL APPROVAL BY OTHERS.
 - THIS SYSTEM IS SUITABLE FOR SLOPING SITES, PROVIDING MAXIMUM PANEL HEIGHT IS THAT SHOWN, AND FOOTING TRENCHES AT SLOPES > 10% ARE LEVEL-STEPPED. TALLER PANELS CAN BE UTILIZED ONLY WITH PROJECT-SPECIFIC CALCULATIONS BY A CALIF LICENSED ENGINEER.
 - FINISH GRADES SHALL SLOPE PER CRC REQS TO DRAIN SURFACE WATER AWAY FROM FDN. EXCEPTIONS CAN BE UTILIZED WITH PROJECT-SPECIFIC PROFESSIONAL CIVIL ENGINEERING.
 - INSTALLATION IN FLOOD HAZARD AREAS SHALL BE PER SHEET 2 OF 2 OF THIS SPA.
 - LOW PROFILE SETS SHALL BE MADE IN CONSIDERATION OF SITE MOISTURE, AND ONLY WHERE SUCH CONDITIONS ALLOW A SUITABLY DRY CRAWL-SPACE. FOLLOW CA STATE DRAINAGE DESIGN WHERE REQUIRED.

MANUFACTURED HOME/MOBILE HOME FOUNDATION SYSTEM

HEALTH AND SAFETY CODE, SECTION 18551

APPROVED

SUBJECT TO CORRECTIONS NOTED

APPROVAL DOES NOT AUTHORIZE OR APPROVE ANY OMISSIONS OR DEVIATION FROM REQUIREMENTS OF APPLICABLE STATE LAWS AND REGULATIONS

State of California

Department of Housing and Community Development

DIVISION OF CODES AND STANDARDS

BY: [Signature] DATE: 9/30/15

SPA NO. 92-2F (Signature)

This Plan Approval Expires: 9/30/17

ANCHORPANEL® FOUNDATION SYSTEM

PERMANENT PERIMETER FOUNDATION FOR MANUFACTURED HOMES

FAST TRACK® Foundation Systems

© US PAT NOS. 6,076,320 6,205,725

ANCHORPANEL.COM (707) 961-1891

MICHAEL BUTLER, CIVIL ENGINEER

BOX 1520, FORT BRAGG, CA 95437

THIS SHEET MAY BE REPRODUCED, IN PART OR WHOLE, ONLY FOR THE PURPOSES RELATING TO AN ANCHORPANEL FOUNDATION SUPPLIED BY FAST TRACK FOUNDATION SYSTEMS. OTHER USES PROHIBITED. THANK YOU



SHEET 1 OF 2

SHEET 2 IS NOT REQUIRED FOR HOMES OUTSIDE OF FLOOD ZONES.

SHEET 2 IS SOLELY FOR MEETING FEMA FLOOD REGS.

FILE: ANCPA16-A
MODIFIED: 02/26/14

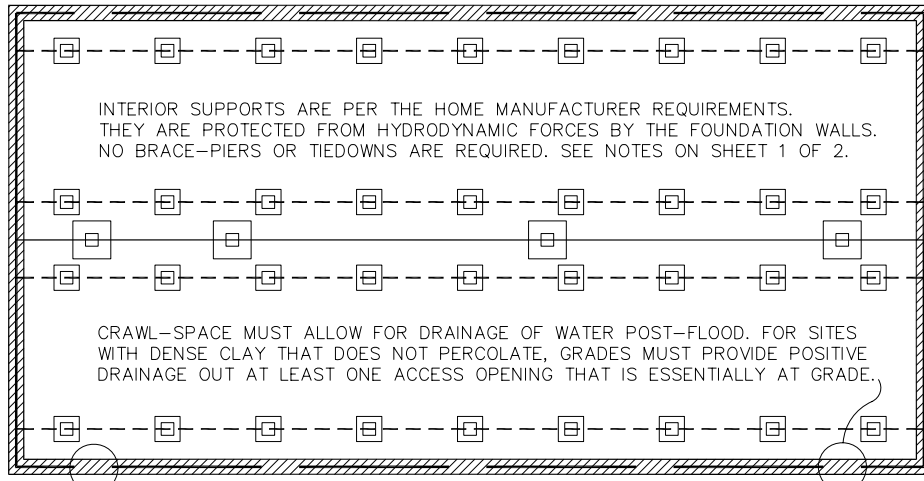

FOUNDATION SCHEMATIC PLAN

SEE SHEET 1 OF 2 FOR SPECIFICS AND LIMITATIONS

ADJACENT GRADES SHALL FALL A MINIMUM OF 6" OVER 10', ALL DIRECTIONS FROM FOUNDATION.

FLOOD / VENT OPENINGS REQUIRED AT BOTH LONGITUDINAL WALLS, WITHIN 12" OF GRADE.

- PROVIDE AT LEAST 1 SQ. INCH OF VENT AREA FOR EACH SQ. FT OF CRAWL-SPACE AREA.
- IF NOT ALSO AIR VENTS, MUST AUTOMATICALLY OPEN TO ALLOW UNOBSTRUCTED FLOW OF WATER.
- BALANCE OPENINGS BETWEEN LONGIT. WALLS.
- TRANSVERSE WALLS SHALL NOT HAVE OPENINGS EXCEEDING 25% OF THE TOTAL WALL WIDTH.
- TRANSVERSE WALLS OF SINGLE-WIDE HOMES MAY NOT HAVE VENT OPENINGS UNLESS INSTALLED WITH NEXT-HIGHER FASTENING SCHEDULE.

OPTIONAL CLADDING OVER FOUNDATION PANELS, MUST BE APPROVED WET-FLOODPROOF MATERIALS.

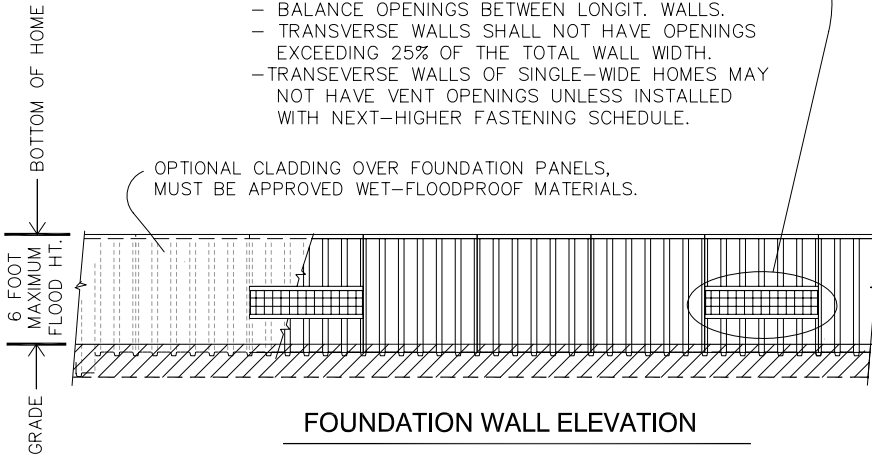

FOUNDATION WALL ELEVATION

SHOWING FEMA-REQUIRED FLOOD VENTS

**MANUFACTURED HOME/MOBILE HOME
FOUNDATION SYSTEM**
HEALTH AND SAFETY CODE, SECTION 18551
APPROVED

SUBJECT TO CORRECTIONS NOTED

APPROVAL DOES NOT AUTHORIZE OR APPROVE ANY
OMISSIONS OR DEVIATION FROM REQUIREMENTS OF
APPLICABLE STATE LAWS AND REGULATIONS
State of California
Department of Housing and Community Development

DIVISION OF CODES AND STANDARDS

BY: [Signature] DATE: 9/30/15

SPA NO. 92-25 (Signature)

This Plan Approval Expires 9/30/17

ANCHORPANEL® FOUNDATION SYSTEM

PERMANENT PERIMETER FOUNDATION
FOR MANUFACTURED HOMES

SHEET 2 OF 2

FLOOD MITIGATION DESIGN REQUIREMENTS

THIS SHEET IS ONLY FOR THE REQUIREMENTS PARTICULAR TO FLOOD MITIGATION
SEE SHEET 1 OF 2 FOR OVERALL FOUNDATION INSTALLATION REQUIREMENTS

SEE NOTES ON SHEET 1.

THIS DISASTER MITIGATING FOUNDATION DESIGN MEETS FEMA-85 FLOOD MITIGATION DESIGN REQUIREMENTS AND 2013 CRC REQUIREMENTS.

THE HOME MUST BE SET ENTIRELY ABOVE THE DESIGN FLOOD ELEVATION, AS THE HOME IS NOT BUILT OF FLOOD-PROOF MATERIALS.

THIS DESIGN IS GOOD FOR ALL TYPE A FLOOD ZONES WHERE THE FLOOD VELOCITY IS UP TO 5 FT PER SEC.

FOOTING DEPTHS MAY BE DETERMINED BY LOCAL BUILDING OFFICIAL REQUIREMENTS WITH REGARD TO FLOOD VELOCITY AND SOIL TYPE. MINIMUMS OF SHEET 1 MAY NOT APPLY.

FAST TRACK® Foundation Systems
© US PAT NOS. 6,076,320 6,205,725
ANCHORPANEL.COM (707) 961-1891
MICHAEL BUTLER, CIVIL ENGINEER
BOX 1520, FORT BRAGG, CA 95437

THIS SHEET MAY BE REPRODUCED, IN PART OR WHOLE, ONLY FOR THE PURPOSES RELATING TO AN ANCHORPANEL FOUNDATION SUPPLIED BY FAST TRACK FOUNDATION SYSTEMS. OTHER USES PROHIBITED. THANK YOU



FILE: ANCSA16-2
MODIFIED: 02/26/14